

Field & Flame

Gas Fire Pit

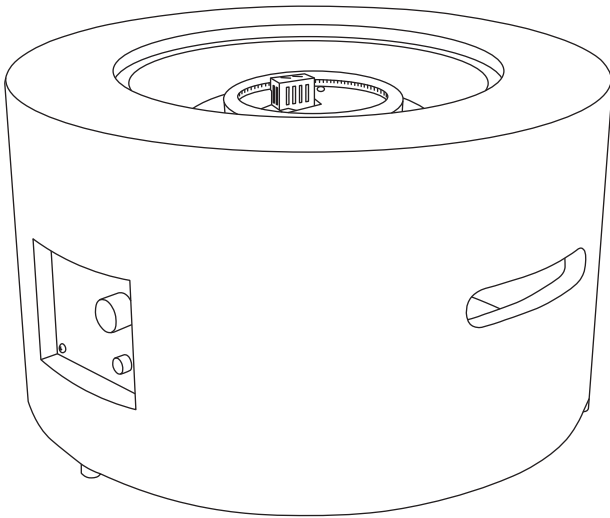

*Image for illustrative purposes only

This manual is for the following models:

Square Bowl Cylinder GF-2012A GF-2011A GF-2016A GF-21056A GF-24001A

www.firedupcorporation.com/manual

WARNINGS

Note: These instructions are only valid if the country code is listed in the instruction manual and the country symbol is on the appliance.

This symbol is stuck on the upper part of the appliance (do not remove!):

Attention:
Surface very hot!
Do not touch!!!



- This appliance is intended for decorative purposes.
- For outdoor use only.
- Not for domestic use.
- Keep the instructions for future reference.
- Do not modify the appliance.
- Do not move the appliance during use.
- Turn off the gas supply at the gas container after use.
- Accessible parts may be very hot. Keep young children away.
- The appliance should not be used in basements or below ground level.
- The appliance must only be used for space heating.



WARNING

Risk of burns! This appliance has a naked flame. A suitable guard should be used for the protection of young children, the elderly and the infirm.



DANGER!

Risk of suffocation due to carbon monoxide!
 This appliance can produce carbon monoxide which has no odour. Using it in an enclosed space can kill you. Never use this appliance in an enclosed space such as a camper, tent, car or home.



ATTENTION: This appliance is equipped with a gas pressure regulator, a flexible gas rubber pipe and clamps that must be used. Never use different kind and always according to the National Rules in force of the country of destination. These components should be periodically substituted, according to the date reported on the body of each of them, or according to the National Rules in force of the country of destination. Gas regulator and LPG cylinder are not included and have to be bought according to LPG compartment shape and cylinder support.

SAFETY INSTRUCTIONS

What to do if you smell gas

1. Close the gas bottle valve.
2. Extinguish open flames.
3. Refrain from igniting an appliance.
4. Do not touch light switches in the vicinity and do not use a telephone in the immediate area.
5. Leave the area and call the gas supplier from your mobile phone.
6. Follow the gas supplier's instructions.
7. If the gas supplier cannot be reached, contact the fire brigade.

General safety instructions



WARNING

Fire and explosion hazard! Failure to observe the instructions, safety instructions and precautions contained in this operating manual may result in fires and explosions that can cause property damage, personal injury or death.

- The appliance is intended for outdoor use only. Never place it on tables!
- Incorrect installation, modification, maintenance or servicing of the appliance may result in property damage and/or personal injury. Before installing, using or maintaining the appliance, read the entire operating instructions and in particular all warnings and safety instructions.
- Failure to follow the instructions in this manual exactly may result in fire or explosion, causing property damage and/or personal injury or death.
- Keep these operating instructions for future use of the appliance. If you are installing the appliance for another person, leave the instruction manual with that person afterwards.
- The following minimum distances must be maintained between the appliance and easily combustible materials: 1.80 m to the top and 0.90 m to all sides (including the back) of the appliance.
- Never place the appliance under unprotected, easily combustible surfaces.
- This appliance must only be installed outdoors in adequately ventilated areas and must not be used inside buildings, garages or other enclosed areas.
- Never use the appliance for heating indoors. Toxic carbon monoxide fumes could accumulate and cause asphyxiation.
- Never leave the appliance unattended during use.
- Never use the appliance at a distance of less than 2.50 m from walls, objects or buildings.
- Do not store the appliance indoors unless the gas cylinder has been removed from the appliance.
- To protect your hands, it is best to use protective gloves when moving the appliance.

- The components sealed by the manufacturer or customer service must not be changed by the user under any circumstances.
- Do not store or use petrol or other flammable liquids within 8 metres of this or any other appliance.
- Do not store flammable materials in the base housing of the appliance.
- Consumption of alcohol, prescription or non-prescription drugs, etc. may impair the ability to safely assemble or use the appliance.
- Do not use the appliance in an explosive environment. Ensure that there are no flammable materials, petrol or other flammable gases and liquids in the area of use of the appliance.
- The appliance must never be used by children. Supervise small children who are near the appliance.
- The appliance must not be installed or used in caravans or boats.
- When using the appliance, observe the applicable local, regional and national regulations. Contact your local fire service for information about outdoor fireplaces.
- When using the appliance, take the same precautions as for an open fire.
- Do not burn solid fuels such as wood, charcoal briquettes, lump charcoal, logs, driftwood, rubbish, leaves, paper, cardboard, plywood, painted, stained or pressure treated wood in this fireplace.
- Do not make any modifications to this appliance.
- Do not use the appliance until it has been fully assembled and all parts of the appliance are securely fastened and screwed down.
- Never store another liquid gas cylinder within 3 metres of the appliance when it is in use.
- Do not use the appliance near cars, trucks, vans or caravans.
- Do not use the appliance under roofs or near unprotected combustible materials. Avoid using the appliance in places with hanging branches or bushes.
- Only place the appliance outdoors on a hard, flat, non-combustible surface, such as concrete, rock or stone. Asphalt or blacktop may not be suitable for this purpose.
- Never use the appliance if any part of it has been submerged in water. Contact customer service or a qualified technician to have the appliance inspected and to replace any components, such as controls or gas regulators, that have been submerged in water.
- Do not wear wide or loose clothing while using the appliance.
- Do not use the appliance when it is windy.
- Keep power cables away from any hot outdoor fireplace.
- Certain components of the appliance are very hot during and immediately after use. Do not touch these surfaces until they have cooled down. Use heat-resistant oven gloves or oven mitts to avoid burns.
- Children and adults should be made aware of the danger posed by hot surfaces of the appliance and should keep a safe distance from the appliance at all times to avoid burns and clothing burns.
- Do not hang or place clothing on or near the appliance.
- Guards removed during maintenance of the appliance must be replaced before operating the appliance.

- Do not move the appliance to another location until it has cooled down completely.
- Do not lean over the appliance while it is being lit or in operation.
- Only use the gas pressure regulator and hose supplied with the appliance. Only use spare parts recommended by the manufacturer.
- Do not store the appliance indoors unless the gas cylinder has been disconnected and removed from the appliance and properly stored outdoors.
- Do not attempt to disconnect the gas regulator from the gas bottle or remove other gas fittings while the appliance is in operation.
- Always turn off the gas bottle valve and the gas pressure regulator when the appliance is not in use.
- Do not sit on the edge of the appliance while it is in operation.
- Do not throw foreign objects into the fireplace while it is in operation.
- Lava rocks become very hot. Keep children and pets away.
- It is extremely important to keep the fireplace valve chamber, burners and recirculation ducts clean. Check the appliance for dirt before each use.
- Visually inspect the gas hose before each use of the gas fireplace for signs of excessive abrasion or wear. If the hose shows any damage, cuts or cracks, it must be replaced before the appliance is next used. The hose must only be replaced with a hose recommended by the manufacturer.
- Remove the lava rocks from the appliance before each use. Inspect the burner and its components. If there is any dirt on them, remove it with a soft brush and a soap solution. Also inspect the areas around the burner. Dirt and foreign objects, such as spider webs or nests, should be removed. If the burners are damaged, they must be replaced before the next use of the gas fireplace.
- The burner unit must only be replaced with a burner recommended by the manufacturer. Lay the hose so that it cannot become a trip hazard.
- Do not step over the gas hose between the appliance and the gas cylinder.
- Before installation, make sure that the local supply conditions (gas type and gas pressure) are compatible with the appliance requirements.
- The appliance must be connected in accordance with national regulations.
- Any air supply must be in accordance with national regulations.

**WARNING**

Fire and explosion hazard! If national regulations require it, it is necessary to replace the flexible hose.

GAS REQUIREMENTS

Warnings for handling propane gas (liquefied petroleum gas)

- Liquefied petroleum gas is flammable and dangerous if handled improperly. Be aware of the properties of propane gas and read the relevant instructions before using a liquefied gas product.

Properties of propane gas: flammable, explosive under pressure, heavier than air and settles in pools in low areas. In its natural form, propane gas has no odour. For your safety, an odourant is usually added. Direct skin contact with propane gas can cause burns. Propane gas is highly flammable and dangerous if handled improperly.

Safety instructions for handling liquid gas cylinders

- Gas cylinders must be stored outdoors in well-ventilated areas out of the reach of children.
- Gas cylinders separated from the appliance must have threaded valve plugs permanently installed and must not be located in buildings, garages or other enclosed areas.
- Never use a gas bottle with a damaged housing, valve, collar or stand.
- Dented or rusted gas cylinders can be dangerous and should be checked by your propane supplier before use.
- The liquid gas cylinder must be designed for vapour extraction.
- The liquid gas cylinder must have a collar to protect the gas cylinder valve.
- LPG cylinders must not be dropped or handled roughly.
- Never store gas cylinders in places where temperatures above 50 °C can be reached.
- Do not store liquid gas cylinders in direct sunlight or near a heat source or source of combustion.
- Never store gas cylinders in a heated car or boot. The heat increases the gas pressure, which can cause the pressure relief valve to open and gas to escape.
- Put the dust cap on the outlet of the gas bottle valve when the gas bottle is not in use. Only use the type of dust cap that was gelled with the gas cylinder valve. Other types of caps or plugs may cause propane gas to leak.
- Never store spare gas bottles underneath or near the appliance.
- Make sure that liquid gas bottles are filled with gas to a maximum of 80% of the total volume.
- Failure to follow the above instructions exactly may result in property damage and/or personal injury and death.
- Liquid gas cylinders should only be filled by a certified liquid gas dealer.
- The gas pressure regulator is set to the gas pressure of the respective country. The outlet pressure of the regulator corresponds to the gas pressure of the respective country.
- Never attempt to connect this appliance to the self-contained LPG system of a caravan, motor home or house.
- Always use the hose and gas pressure regulator supplied with the appliance to connect the appliance to a liquid gas cylinder. Never connect the appliance to an unregulated liquid gas supply.
- Contact customer service for spare parts.
- Only open or close the gas cylinder valve by hand. Never use tools to do this. If the valve cannot be turned by hand, do not attempt to repair it yourself. Contact a certified gas technician. Using force or attempting to repair it can lead to fire and explosion.

Notes on connecting the gas bottle to the appliance

- Only use the type of gas and gas bottle recommended by the manufacturer.
- The appliance is equipped with a gas pressure regulator, flexible rubber gas hose and clamps that comply with the national regulations in force in the country of destination.
- The appliance must be equipped with an approved gas pressure regulator (approved for an operating temperature of at least 50 °C) in accordance with the EN standard (see information on the required gas pressure in section "Gas specifications" as well as the description of the connection of the gas pressure regulator at the inlet and outlet according to the applicable national regulations in the section "Assembly") and a flexible gas hose according to EN 16436-1 (with a suitable inner diameter corresponding to the connection at the gas inlet according to the applicable national regulations) with a maximum length of 2 m and approved for an operating temperature of at least 60 °C). Replace the gas pressure regulator, the flexible rubber gas hose and the clamps only with spare parts recommended by the manufacturer. The gas pressure regulator should be replaced at least every 10 years.
- Handle the flexible gas hose with care. Make sure that it is not twisted or kinked. Never use a damaged gas pressure regulator.
- Never connect the appliance to an unregulated gas source (the use of a gas pressure regulator is mandatory).
- When the appliance is not in use, turn the gas cylinder valve to "OFF".
- The flexible gas hose must be inserted carefully into the gas bottle compartment. Make sure that it is not twisted in the process.
- After connecting a gas bottle, always carry out a leak test of the gas connections using a soap solution. If bubbles form, this indicates a leak. Do not use the appliance until you have fixed the leak. Never carry out a leak test with an open flame! **This is strictly forbidden and dangerous!**
- Always change gas cylinders in a well-ventilated area outdoors, at a safe distance from sources of ignition.
- Place the gas bottle at a minimum distance of 60 inches (approx. 1.5m) from the gas fireplace (see illustration below).

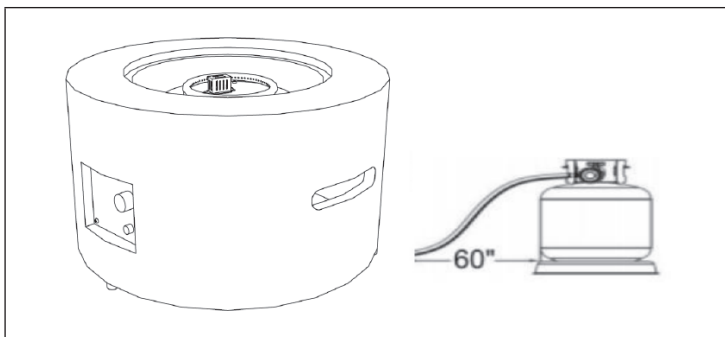

DEVICE OVERVIEW

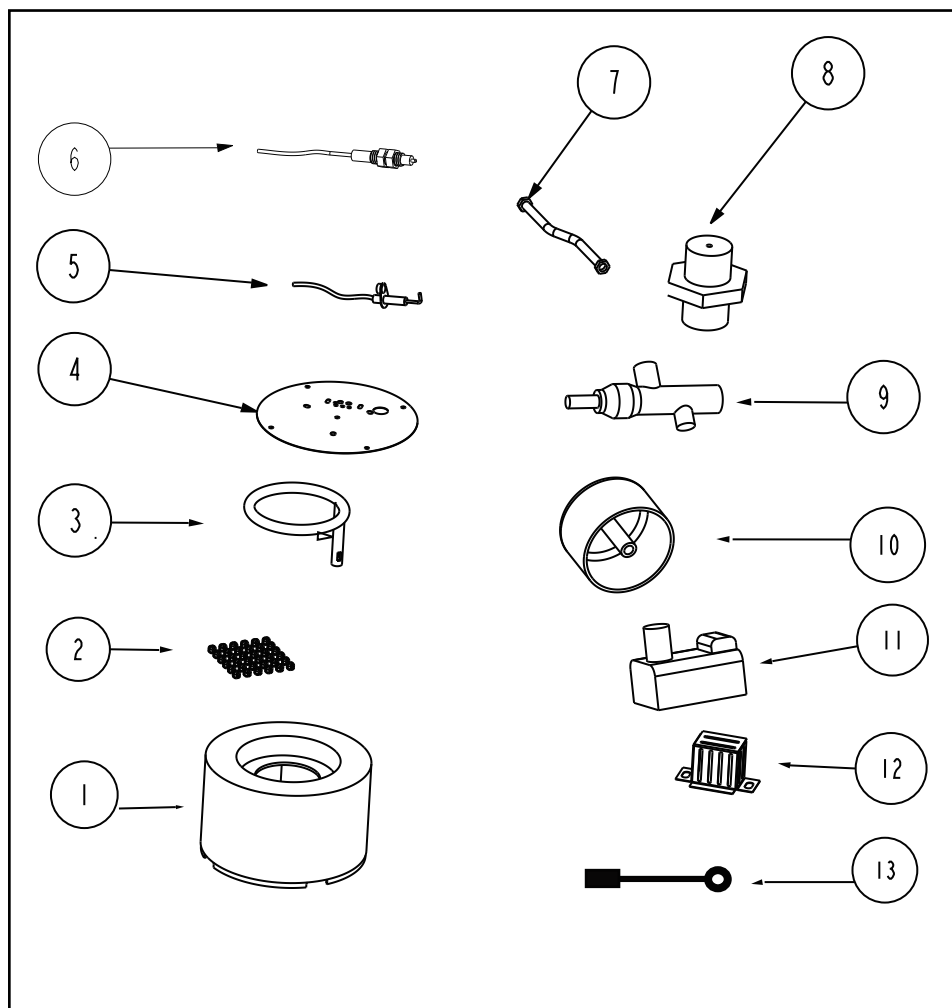

1	Body	1 pc.	8	Injector	1 pc.
2	Lava rocks	1 pc.	9	Gas valve	1 pc.
3	Burner	1 pc.	10	Control knob	1 pc.
4	Fire bowl pan	1 pc.	11	Pulse ignition	1 pc.
5	Ignition pin	1 pc.	12	Ignition screen	1 pc.
6	Thermocouple	1 pc.	13	Grounding wire	1 pc.
7	Corrugated pipe	1 pc.			

ASSEMBLY

- Keep this instruction manual for future reference.
- If you have already opened the box and removed all packaging, ignore steps 1 and 2. Go directly to step 3.

Step 1

1. Open the carton and remove all the components. Make sure that the package is complete.
2. Remove the box and make sure that no accessories remain in the box.
3. Remove all the packaging material except for the honeycomb paper around the fire bowl.

Step 2

1. Place the fire bowl upside down on a flat surface.
2. Remove all the honeycomb paper that is around the fire bowl.

Step 3

1. Check all components before using the appliance. Before assembling, make sure that the gas cylinder valve is in the "OFF" position (see figure A on the next page).
2. Remove the plastic film from the battery. Unscrew the rubber cap of the electric igniter and insert the AA battery into the battery compartment. Make sure the positive (+) terminal is facing the rubber cap. Screw the rubber cap firmly back onto the battery compartment (see figure B).
3. Place the lava rocks centrally on the top of the fire bowl (see illustration C).
4. Do not cover the ignition screen when placing the lava rocks in the fire bowl. Always make sure that the ignition screen is visible. Connect the gas pressure regulator to the gas bottle (see illustration D).
 - ① Turn the gas bottle valve clockwise to close the gas supply on the gas bottle.
 - ② Turn the gas pressure regulator coupling clockwise by hand only. Make sure that it is firmly seated.

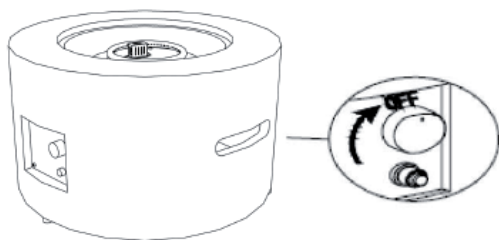
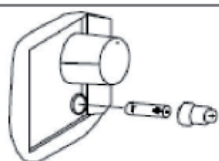
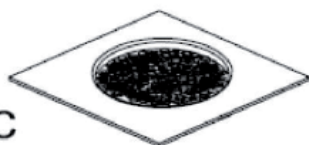
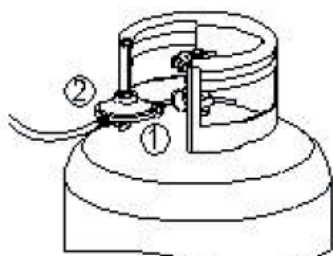
STEP 3**A****B****C****D**

Note on filling the lava rocks

Note: The ignition screen must be free and unobstructed at all times to ensure proper operation.

Note: Do not place lava stones on the ignition screen. Make sure that the ignition screen is visible at all times.

Screen



Note: The burner of the fire bowl must be completely covered with lava stones. Otherwise, the flames could be smothered (for correct positioning, see illustrations on the right).



CORRECT



INCORRECT

Leak test

Only carry out the leak test in a well-ventilated area outdoors where no sparking can occur. Remove the battery from the igniter. Open the gas cylinder valve fully (anti-clockwise). Set the regulator of the appliance to the "OFF" position. To pressurise the hose. Check all connections for leaks with a soap solution before igniting the appliance. If a leak is found, close the gas cylinder valve and do not use the appliance again until the leak has been repaired.

COMMISSIONING AND OPERATION

Before use

- Read the entire operating instructions carefully.
- Make sure that the scope of delivery is complete.
- Keep the operating instructions for future use.

Switch on (ignite flame)

Inspect the gas hose before each use. Replace the hose if there are any cuts, damage or signs of wear.

- (1) Turn the gas cylinder valve anticlockwise to open the gas supply.
- (2) Close the door of the gas bottle container of the gas fireplace.
- (3) Ignite the gas fireplace as described below:

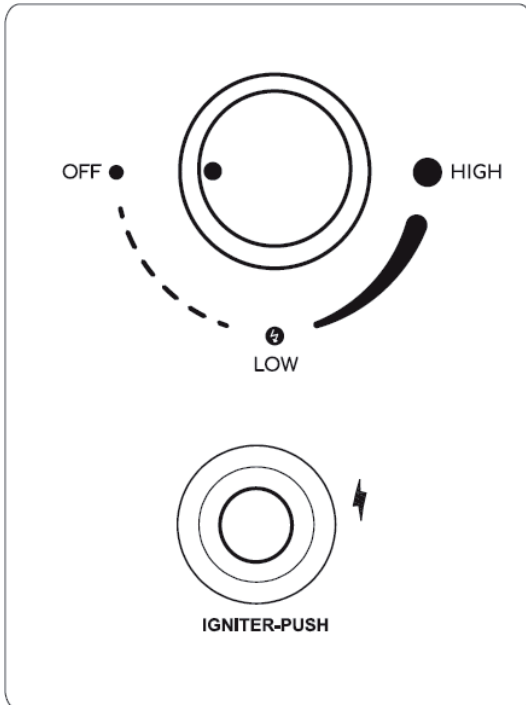

1. Press and hold the electric igniter. At the same time, press the control knob and turn it anticlockwise to the "LOW" position. Continue to hold down the control knob to ignite the burner.
2. Release the electric igniter after ignition. Keep the control knob pressed for another 45 seconds.
3. If ignition does not occur within a few seconds, turn the control knob to the "OFF" position. Wait 5 minutes and then repeat the ignition process as described above.

**CAUTION**

Risk of fire and injury! If the burner does not ignite when the valve is open, gas will continue to flow out of the burner and may accidentally ignite, posing a risk of injury.

- Pay attention to the flame height when the appliance is lit.
- The flame should have a yellow/blue colour and be between 5 and 25 cm high.

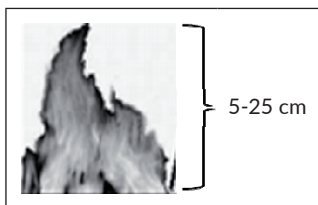
**Switch off (extinguish flame)**

1. Turn the control knob clockwise to the "OFF" position.
2. Turn the gas cylinder valve to the "OFF" position.
3. Let the appliance cool down completely before moving it (at least 30 minutes).

Reignite

1. Turn the control knob to the "OFF" position.
2. Wait at least 5 minutes to allow the gas to dissipate completely before trying to light the burner again.
3. Repeat the steps in the section "Switch on (ignite flame)".

LEAK TEST

Never check for gas leaks with a flame or while smoking. This appliance must be checked regularly for leaks. Immediate inspection is required if there is a smell of gas.

- Prepare a soap solution that is 1 part dishwashing liquid and 3 parts water. The soap solution can be applied with a bottle, brush or rag to the leakage check points shown in the illustration (below).
- The gas cylinder valve should be in the “OFF” position at the time of the leak test. Once the soap solution has been applied to the gas connections, the gas cylinder valve must be turned to the “ON” position.
- In the event of a leak, soap bubbles will form in the soap solution.
- Should a gas leak occur, the appliance must not be used. As soon as a leak occurs (and in case of fire), cut off the gas supply and inspect and repair the appliance before using it again. Tighten any leaking connections, turn on the gas supply and check again for leaks.
- If necessary, replace the gaskets (according to EN 549 class B2) or the material used to ensure tightness (according to EN 751-1 class 1).

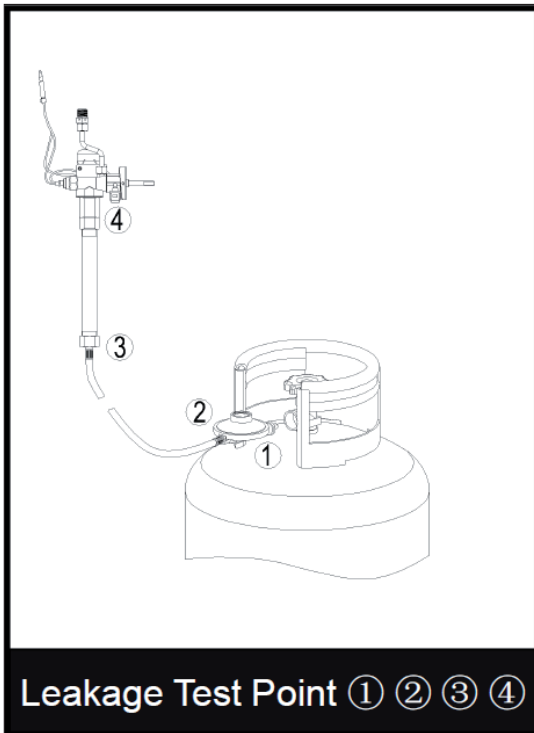

CLEANING AND MAINTENANCE

In order to enjoy your appliance for a long time, regular maintenance of the appliance is necessary. Please note the following:

- The appliance should be checked at least once a year by a qualified technician. Depending on the use of the appliance, more frequent cleaning may be required.
- All guards that have been removed to service the appliance must be replaced before the appliance is put into operation.
- Keep the external surfaces of the appliance clean and free from flammable materials.
- Use warm soapy water for cleaning. Never use flammable or corrosive cleaning agents.
- When cleaning, make sure that the area around the burner unit always remains dry. If the gas regulator has come into contact with water in any way, never attempt to use the appliance. It must be replaced.
- The air circulation ducts of the burner and the gas bottle container must be kept clean at all times.
- The air supply must not be obstructed. Keep the regulator, burner and recirculation air ducts clean. Signs of a possible blockage include:
 - Gas smell with extremely yellow flame tip/the appliance glows excessively unevenly/the appliance makes popping noises;
 - Spiders and insects may nest in the burner or burner openings. This can create dangerous conditions that make the appliance unsafe to use. Clean the burner openings with a pipe cleaner. Compressed air can help remove smaller particles.
 - Carbon deposits are a fire hazard. Remove carbon deposits with warm soapy water.
- Once the burner and lava stones have cooled down completely, remove them from the fire bowl and remove stains, dirt particles and soil with a soft brush. Wipe with a soft cloth.
- Clean the fire bowl and then put the lava stones back in place.
- A Hoover can be used for thorough cleaning.

Note: In areas with salty air (e.g. near the sea) corrosion occurs more quickly than usual. Check corroded areas regularly and repair them immediately. Stubborn stains, discolouration and rust may occur if the appliance is exposed to extreme conditions. Be careful not to allow powder or solvent to come into contact with painted components or plastic parts as this may damage the appliance. Some discolouration of the appliance may occur after prolonged use. This is normal.

- Make sure that both gas supply controls are in the “OFF” position before replacing the battery (see step 3 of the “Assembly” section).
- For information on replacing hoses, thermocouples, igniters, lava stones, etc., contact the manufacturer or customer service.

Note: Never use spare parts not approved by the manufacturer. Only use original spare parts and components. Failure to do so may invalidate the warranty and result in unsafe operating conditions.

Storage (after use)

- Turn the control knob to the “OFF” position.
- Turn the gas cylinder valve to the “OFF” position.
- Store the appliance in a cool, dry place away from direct sunlight. Store the appliance upright in an area protected from direct weather (rain, hail, snow, dust and dirt).
- Cover the appliance if necessary to protect the external surfaces and to avoid deposits in the recirculation air ducts.

Note: Wait until the appliance has cooled down completely before covering it.

For longer periods of non-use and transport

If you are not going to use the appliance for a long time or if you want to transport it:

- Turn the control knob to the “OFF” position.
- Disconnect the gas bottle and move it to a well-ventilated place outdoors. Do not store the gas bottle in a place where temperatures above 50 °C can be reached.
- Store the appliance in a cool, dry place away from direct sunlight. Store the appliance upright in an area protected from direct weather influences (rain, hail, snow, dust and dirt).
- If necessary, cover the appliance to protect the external surfaces and to avoid deposits in the recirculation air ducts.

Note: Wait until the appliance has cooled down completely before covering it.

TROUBLESHOOTING

Problem	Possible cause	Possible solution
Burner does not ignite.	The control knob is not in the maximum position (big flame).	Turn the control knob to the maximum position (big flame).
	The gas bottle valve is closed. Or: The gas bottle is empty.	Open the gas bottle valve. Replace the gas bottle.
	Blockage in the injector.	Clean or replace the injector.
	Low gas pressure	Replace the gas bottle with a new one.
	Air in the gas circuit	Open the gas supply and vent the gas line (by pressing the control knob) for max. 1 minute, or until you smell gas.
	Igniter does not work.	Ignite the burner with a match. Replace the battery or replace the igniter.
Burner won't stay lit	Dirt deposits in the burner area.	Clean the burner area.
	Low flames or not full running around the burner.	The flame-spreader holes are partially blocked. Clean the burner.
	Thermocouple not working properly.	Replace the thermocouple.
	Low gas pressure.	Replace the gas bottle with a new one.

Problem	Possible cause	Possible solution
Burner flame is low. Note: Do not use the appliance at temperatures below 5 °C.	The outside temperature is higher than 5 °C and the gas bottle is less than 25 % full.	Replace the gas bottle with a new one.
	Gas hose is bent or kinked.	Straighten the gas hose and carry out a leak test on the gas line.
	Control knob is in the maximum position (big flame).	Turn the control knob to the "OFF" position. Close the gas cylinder valve. Let the appliance cool down and check the burner and the burner openings for blockages.
Carbon deposits	Dirt or film on the burner	Clean the burner.
Flame flashback (flame in burner)	The burner ports are blocked.	Move the control knob to the "OFF" position. Close the gas cylinder valve. Wait 2 minutes and follow the instructions for the ignition process. Try to ignite the burner again. If the problem persists, contact the manufacturer.
Thick black smoke	Blockage in the burner	Turn the control knob to the "OFF" position, let the appliance cool down to room temperature, remove the blockage and clean the burners inside and out.

DISPOSAL CONSIDERATIONS



(WEEE) Waste Electrical and Electronic Equipment.

Waste electrical products should not be disposed of with household waste. Please recycle where facilities exist. Check with your Local Authority or retailer for recycling advice.

GUARANTEE

For your convenience, you are not required to complete a form and return it to us in order to validate your guarantee. However, please ensure that you retain your receipt which will act as both proof of purchase and a guarantee validation document. **We recommend that you attach your receipt to this documentation.**

Your product carries a 12 month guarantee from the date of original purchase (or as otherwise provided in writing at point of purchase). If your product fails to operate to its specification, due to faulty workmanship or materials during the guarantee period, we will either repair or replace the product. We will use our discretion to determine whether to offer a repair or provide a replacement. The product will not be covered by the guarantee if it has been misused, transformed, modified or altered in any way.

If your product fails within the guarantee period please ensure that you have all necessary documentation available including proof of purchase (receipt or invoice with serial number, location and date of purchase) in addition to all original undamaged packaging and leaflets etc. It is strongly recommended that you inspect your product carefully before it is used or installed. For full details of your product you should refer to the instruction manual which accompanies the product. You are strongly advised to read this manual carefully in its entirety and to retain it for future reference.

This product guarantee does not affect your statutory rights.

CUSTOMER HELPLINE

 +44 (0) 3300 882 069

 customer.support@firedupcorporation.com



www.firedupcorporation.com

Fired Up Corporation Ltd
Fired Up Buildings
HD1 3LF, UK

Fired Up Corporation
(Ireland) Ltd
71, D02 P593, Dublin